

# New Premium Window Regulators

FOLLOW US ON SOCIAL MEDIA



## Component Upgrades

### 1. Stronger Rail Guides

**Benefit:** Improves durability and reduces flexing or bending during operation, leading to smoother and more consistent window movement over time – especially important for larger or heavier glass panels.

### 2. Reinforced Pulleys

**Benefit:** Enhances the mechanical strength and longevity of the pulley system, minimizing the risk of pulley deformation or breakage, which helps prevent cable misalignment or failure.

### 3. Pre-tensioned Cables

**Benefit:** Optimal tension is applied during manufacturing for faster, easier installation and consistent operation without manual adjustment – eliminates slack or binding.

### 4. Reinforced Cable Sleeves

**Benefit:** Protects cables from abrasion and wear, especially where they pass through guides or tight spaces. This helps extend the lifespan of the regulator and prevents cable fraying or breakage.

### 5. Pre-lubed Tracks

**Benefit:** Reduces friction during window movement, ensuring quieter, smoother operation and less strain on the motor – while also lowering the risk of seizing or binding over time.

### 6. OE Plug & Play Harness

**Benefit:** No wire splicing required.

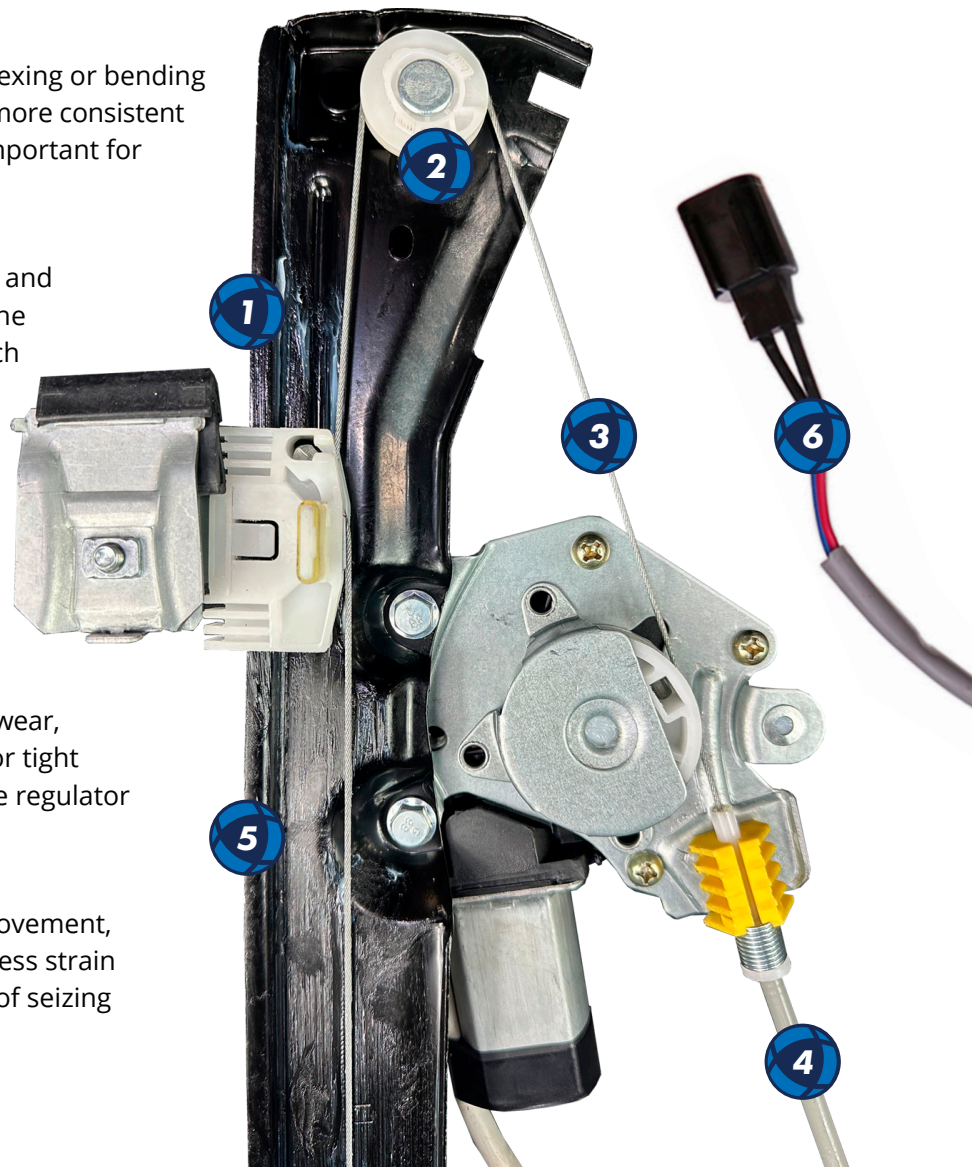

Improving OE Quality by Design

# New Premium Window Regulators

FOLLOW US ON SOCIAL MEDIA



## Premium Features

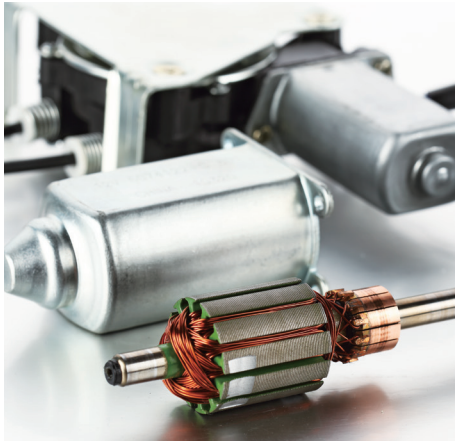

### Premium Motor Design

Built with high-strength, temperature resistant materials that ensure long-life in the harshest conditions.

- Magnetic shoes & Morgan brushes
- Water-proof film & Omron thermal protector



### Extensive Testing

Each window regulator undergoes rigorous tensile testing to ensure no wire separation occurs.

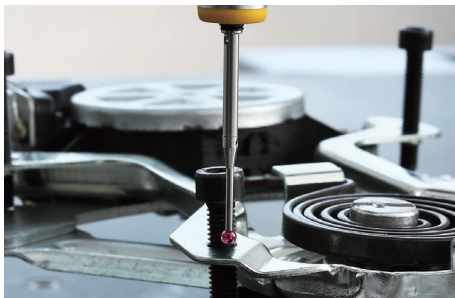

### Perfect Fit, Form & Function

Achieved through 3D coordinate measuring technology.

## Window Lift Types

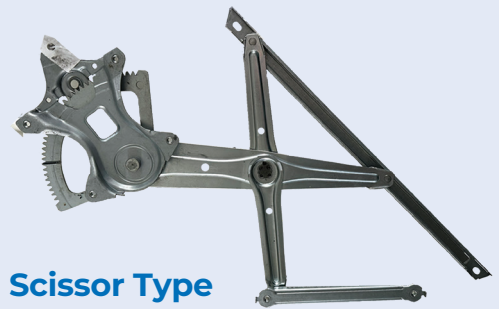

Scissor Type

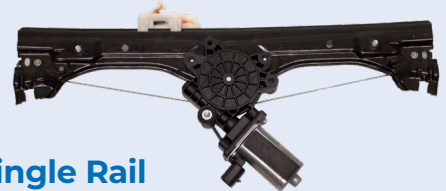

Single Rail

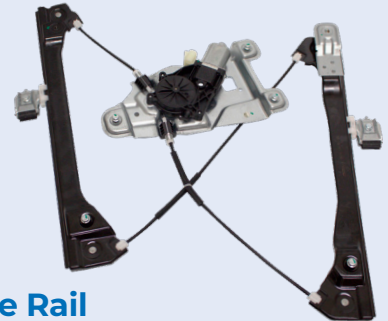

Double Rail

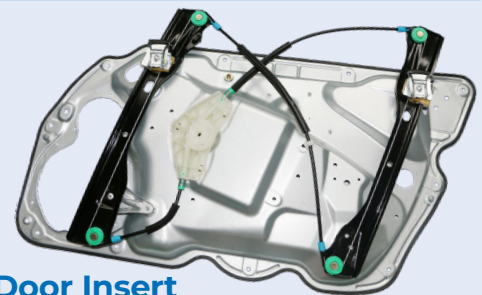

Door Insert